

keypadCUE-8-E

CS0288

Description

Featuring a beautiful stainless steel architectural finish, this keypad is an elegant and powerful wall-mounted control panel designed to be built into a standard European electrical wall box. The keypad provides 8 buttons and programmable indication. Button labels can be engraved upon the organic glass strips on the front panel. The built-in IR receiver makes it possible to use irCUE panel in the room where keypadCUE-8-E is installed, without necessity to install a separate IR receiver. The full function console keypad may be used as a dedicated wired control panel for audio, video and operating environment functions.

Addressing

keypadCUE-8-L has two different addresses – one for keypad buttons and indication LEDs, the other for the built-in IR receiver.

Keypad buttons address:

The ADDRESS can be set in the range 0 to 207
Default ADDRESS is 1

IR receiver address:

The ADDRESS can be set in the range 0 to 255
Default ADDRESS is 0

The addresses of the keypadCUE-8-L are stored in internal flash memory. For modification of addresses see user manual.

keypadCUE-8-E front view

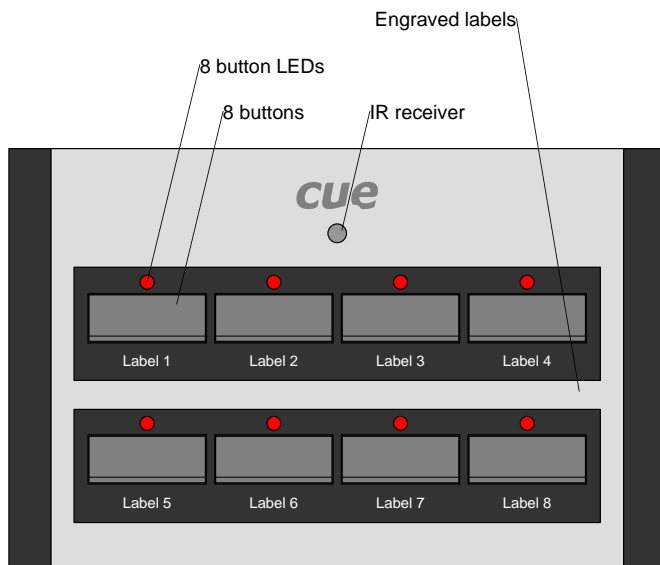

keypadCUE-8-E rear view

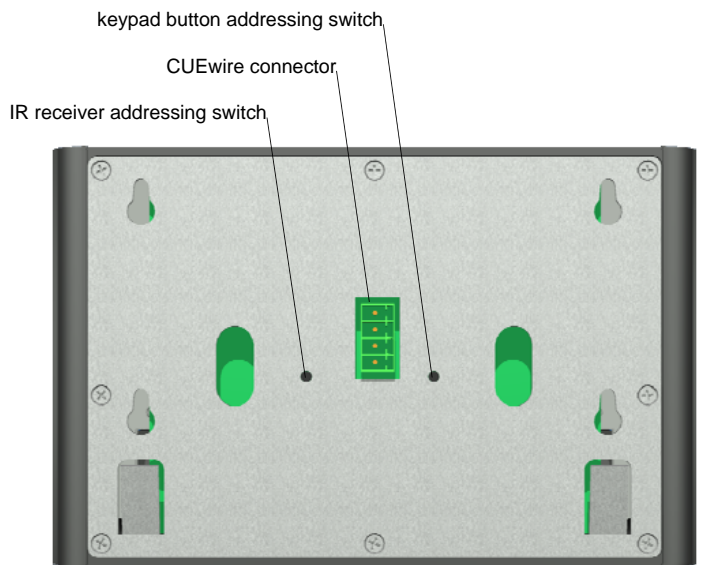

Connecting

CUEwire connector			
Pin	Signal	Description	Phoenix 4-pin 3.5 mm
1	+24	Power +24 VDC	
2	G	Ground	
3	A+	RS-485 Data +	
4	B-	RS-485 Data -	

